



6016-2Z Deep groove ball bearings

- Popular item
- SKF Explorer

Deep groove ball bearings

Bearing data

[Tolerances](#),

Normal (metric), P6, P5, Normal (inch),

[Radial internal clearance](#),

Matched bearing pairs, Stainless steel
 $d < 10$ mm, Other bearings

Bearing interfaces

[Seat tolerances for standard conditions](#),

[Tolerances and resultant fits](#)

Technical specification

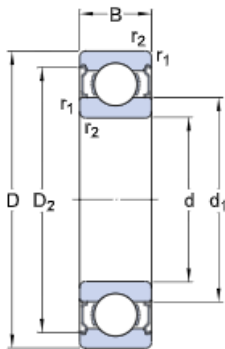

DIMENSIONS

d	80 mm	Bore diameter
D	125 mm	Outside diameter
B	22 mm	Width
d_1	≈ 94.4 mm	Shoulder diameter
D_2	≈ 114.1 mm	Recess diameter
$r_{1,2}$	min. 1.1 mm	Chamfer dimension

ABUTMENT DIMENSIONS

d_{ξ} min.	86 mm	Diameter of shaft abutment
d_{ξ} max.	94.3 mm	Diameter of shaft abutment
D_{ξ} max.	119 mm	Diameter of housing abutment
r_a max.	1 mm	Radius of shaft or housing fillet

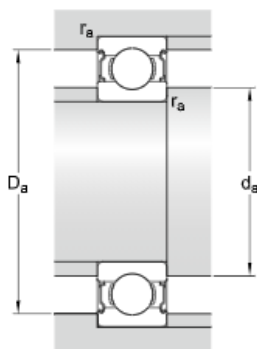

CALCULATION DATA

C	49.4 kN	Basic dynamic load rating
C ₀	40 kN	Basic static load rating
P _u	1.66 kN	Fatigue load limit
	11 000 r/min	Reference speed
	5 600 r/min	Limiting speed
k _r	0.025	Minimum load factor
f ₀	15.6	Calculation factor

MASS

	0.89 kg	Mass bearing
--	---------	--------------

TOLERANCE CLASS

P6	Dimensional tolerances
Normal	Radial run-out